



PALLADIUM

ANDHERI EAST



A2O REALTY
ARIF FAZLANI GROUP

AN ICONIC LANDMARK
WITH MODERN
ARCHITECTURE
AT ANDHERI EAST,
POSSESSION BY
DECEMBER
2025

Artist's Impression

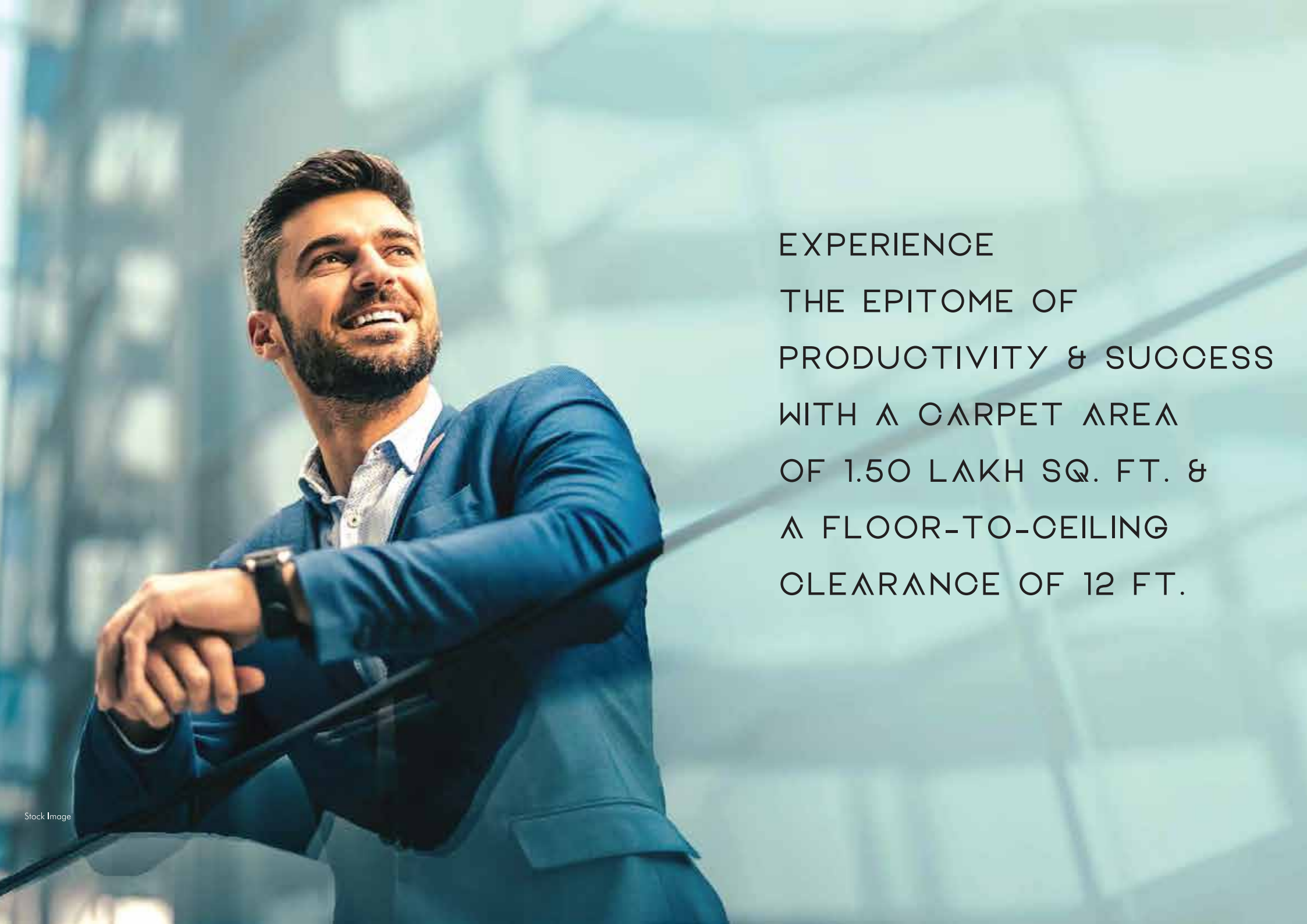
A man with a beard and short dark hair, wearing a blue blazer over a light blue button-down shirt, is leaning on a dark metal railing. He is looking upwards and to the right with a slight smile. The background is a blurred city skyline with tall buildings under a clear sky.

EXPERIENCE
THE EPITOME OF
PRODUCTIVITY & SUCCESS
WITH A CARPET AREA
OF 1.50 LAKH SQ. FT. &
A FLOOR-TO-CEILING
CLEARANCE OF 12 FT.



WHERE AESTHETICS
MEET FUNCTIONALITY



- A premier commercial property in the heart of Andheri East



- Ideal for standalone building.



- Strategically situated at the most premium location of Andheri East



- Excellent connectivity to all prime locations of the city



- Ease of access through various transportation modes



- Intelligently planned and generously spacious office spaces spanning from the ground to the sixth floor



- Imposing facade design conspicuously visible from a distance



- Large and convenient basement parking with a total capacity of around 160 spaces



A man and a woman are walking together in a modern, brightly lit office lobby. The man is on the left, wearing a dark blue suit, a white shirt, and a patterned tie. He is looking towards the woman. The woman is on the right, wearing a dark blue blazer over a black and white checkered dress, and black high-heeled sandals. She is looking back at the man. They are walking on a polished floor that reflects the light. In the background, there are large glass windows and a modern architectural design with a curved ceiling.

EXPERIENCE THE
EPITOME OF
SOPHISTICATION AND
PROFESSIONALISM

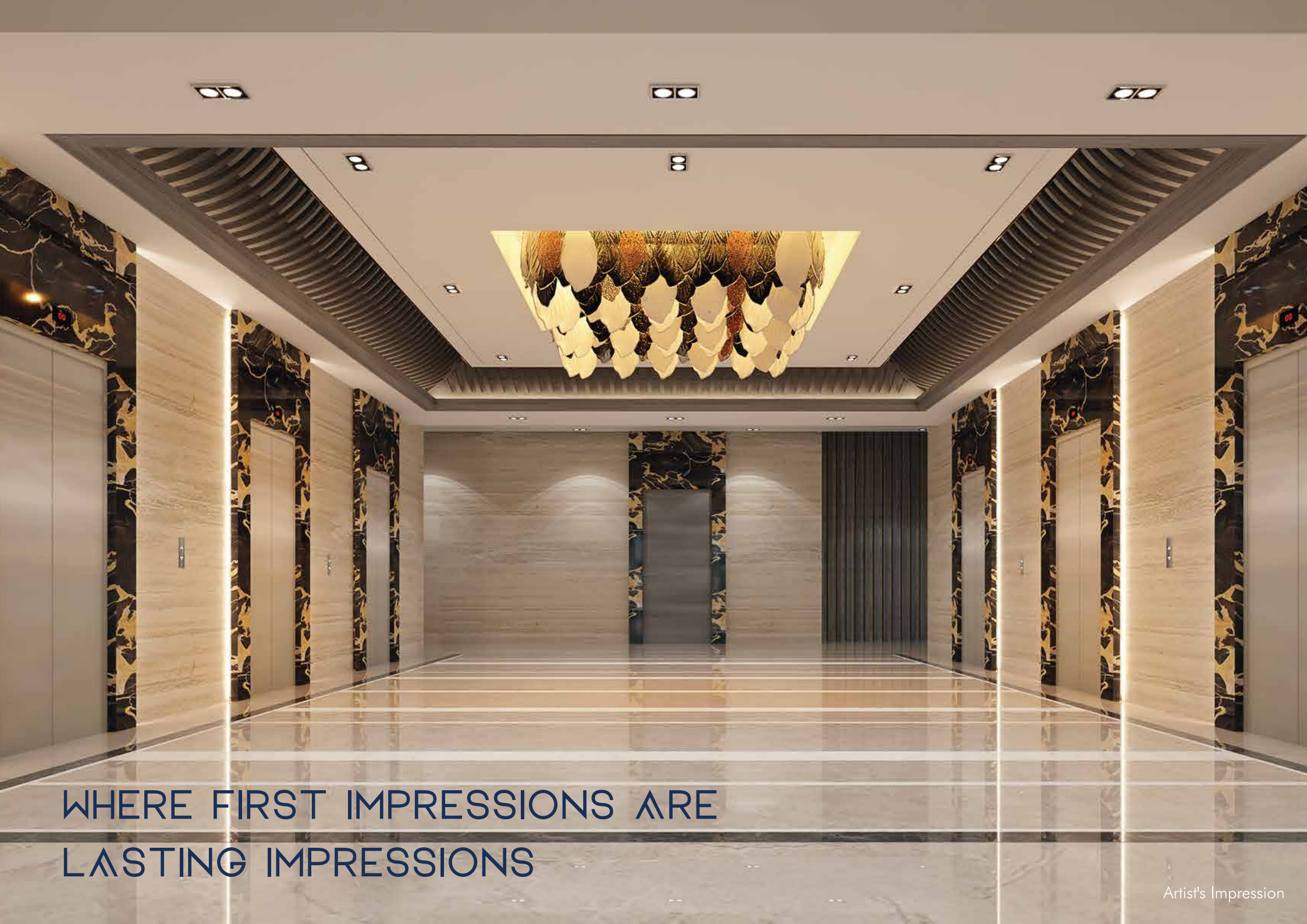

WHERE FIRST IMPRESSIONS ARE
LASTING IMPRESSIONS



WHERE ELEGANCE MEETS
CONVENIENCE



ANDHERI EAST

GETS ITS NEXT BIG
COMMERCIAL CYNOSURE
IN THE PALLADIUM

BY **A2O**
REALTY
ARIF FAZLANI GROUP

WHERE COMMERCIAL ASPIRATIONS MEET ACCESSIBILITY

- Chakala Metro Station: 950 m.
- CSIA: 2.2 kms.
- Western Express Highway: 2.2 Kms.
- Andheri Railway Station: 3.4 Kms.
- Ghatkopar Railway Station: 6.6 kms.
- Eastern Express Highway: 9 kms



A2O REALTY
ARIF FAZLANI GROUP





A photograph of two men in business attire shaking hands in a modern office. They are seated in beige armchairs around a small white table with a laptop. The background features large, textured gold-colored geometric shapes and a window. The right side of the image is overlaid with a solid dark blue background containing white text.

EMBRACE A FUTURE
PROFUSE WITH
INTELLIGENT DESIGN

BASEMENT FLOOR PLAN

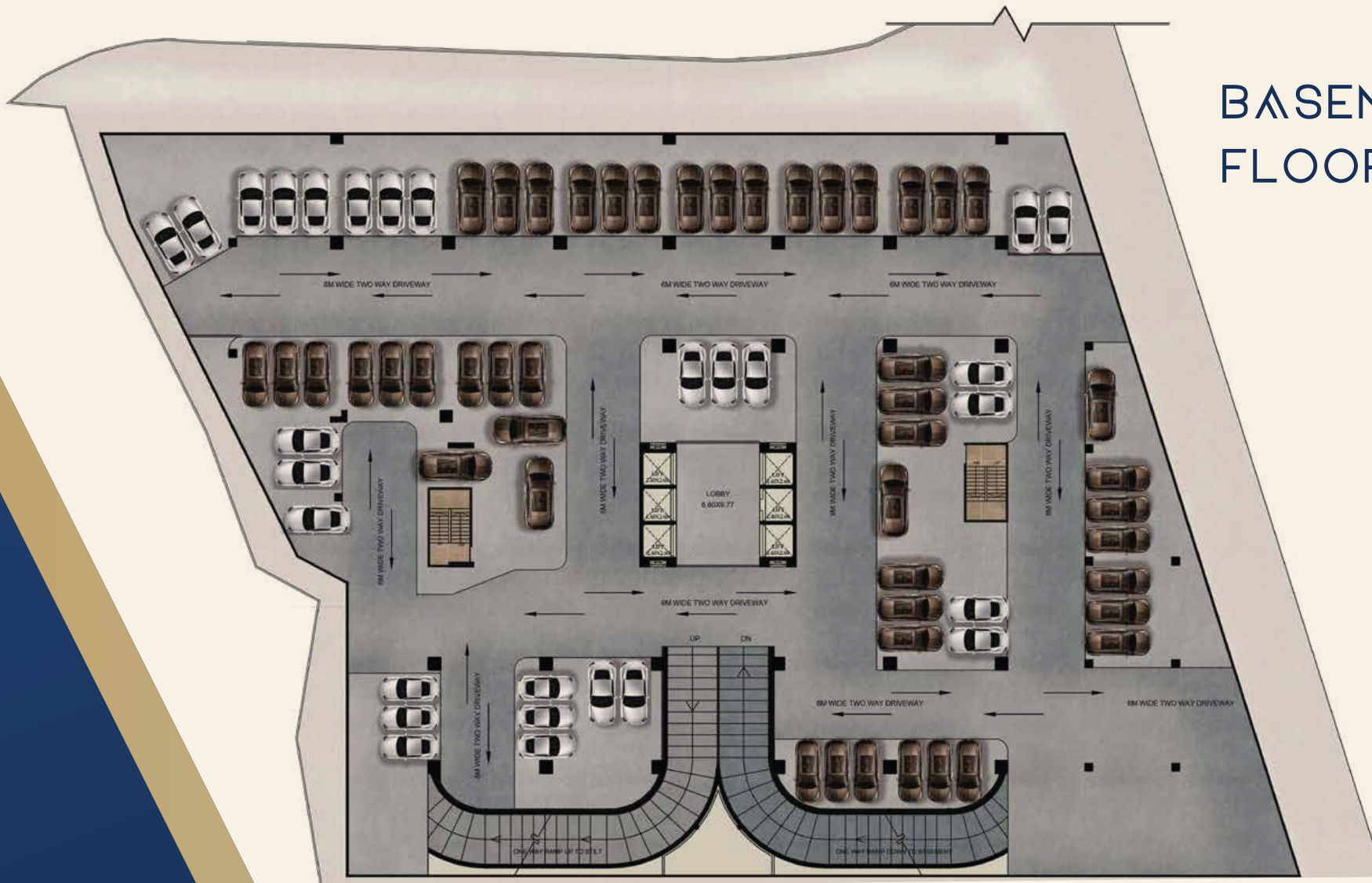

GROUND FLOOR PLAN

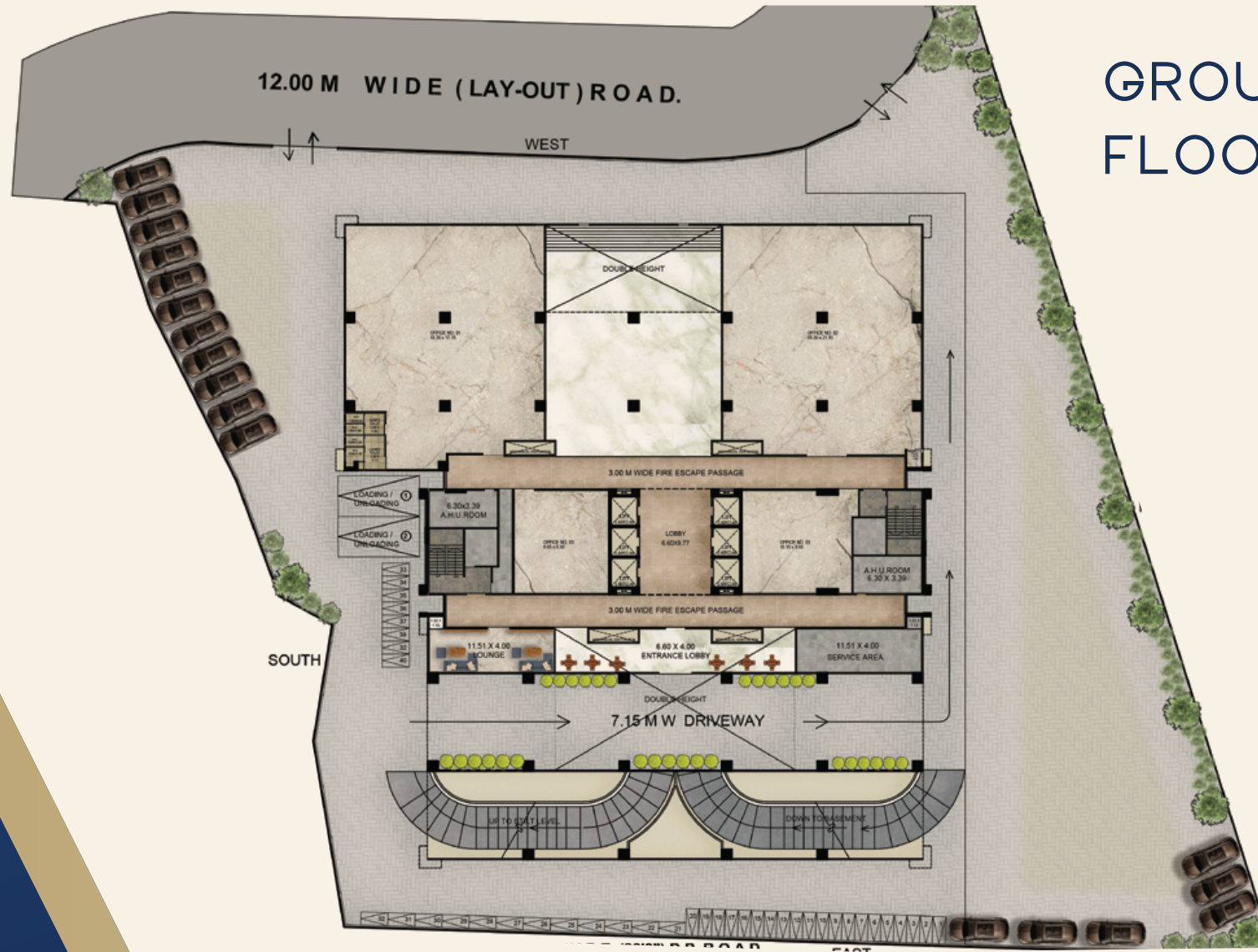



2ND TO 7TH FLOOR





A SPACE DESIGNED ONLY WITH
YOUR BUSINESS IN MIND

A2O

REALTY

ARIF FAZLANI GROUP



PALLADIUM

ANDHERI EAST

WHERE POSSIBILITIES ARE ENDLESS
AND PROSPECTS, MATCHLESS

A2O

REALTY

ARIF FAZLANI GROUP

www.a2o.com

: info@a2o.com |  : 78678 78786

OFFICE ADDRESS: 1208 Ozone Biz Centre, Mumbai Central, Mumbai 400 008.

Disclaimer: All the images, pictorials, visuals, elevations, perspectives, illustrations, model, stock images, specifications, plans, designs, drawings, dimensions, maps, facilities, amenities, features, and other information / details herein are conceptual, indicative and for representation purpose only and are not to scale, and is subject to the approval of the respective authorities. The Promoters / Developers / Architect reserve the right to add, alter, delete or replace any of these in the interest of the development, without any notice or obligation. All the matter presented here at the exhibition does not constitute any offer or contract of any nature whatsoever between the Promoters / Developers and the recipient. All transactions shall be subject to and governed by the terms & conditions of the Agreement for Sale to be entered into between the parties. Stock image used for representational purpose only

The project is registered via MahaRERA registration number: P51800031821 and is available on the website: <https://maharera.mahaonline.gov.in> under registered projects.